

The SAG RAG is published bi-monthly by the Shasta Area Grotto of the National Speleological Society. Editors: Jim and Liz Wolff, PO Box 865, McCloud, Ca. 96057. Printing: Ray Miller. Grotto meetings are held the second Friday of the month at 7:30 pm. Meeting places are announced in the newsletter. Dues are due January 1, prorated by quarter, \$6. Subscriptions are \$6/year.

### CAVER'S CALENDAR

**March 10** – SAG Meeting at Wolff's,  
6 Mill Rd., McCloud CA (916) 964-3123

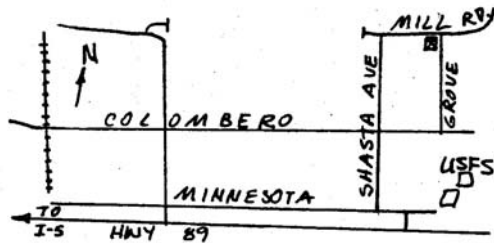

**April 14** – SAG Meeting at Smith's  
3645 Summit Dr., Redding CA (916) 246-3942

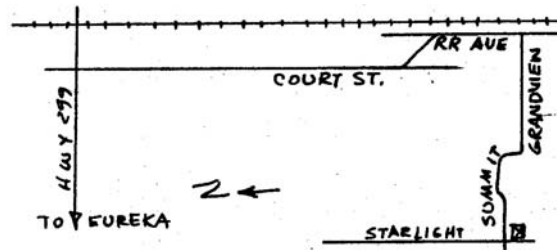

### **TRAPPED EXPLORERS RESCUED AFTER 5 DAYS** (Assoc. Press 12/11/88)

Nineteen cavers were trapped in Holloch (Switzerland), one of Europe's largest caves, due to flooding from an unexpected heavy rain storm. The 14 youths, aged 11 to 18, and five adults retreated to a dry spot, where they stayed until rescued. The article said they were well-equipped with food and camping equipment.

### **LOOSE ENDS and MORE LEADS for 1989**

- **Porcupine Butte Lava Tube**, the upper level and the upper-level maze need to be mapped and the mirabilite snowballs need to be photographed. Also the lower end of the cave continues as air movement can be felt beyond the fault line.
- There are about two hundred feet of passage in the upflow end of **Sign Cave** needing to be surveyed. Continuing passages have been found in **Sign** and **Hourglass Caves**, so there should be a continuation of **Porcupine Butte Cave** as well, below the fault line.
- **Water Caves** complex survey needs to be finished. Peter Bosted et al. started surveying this huge lava cave system awhile back but didn't get finished. It's a big project and will prove to be worth while. Perhaps we should join forces some day and have a Cavefest out there as a joint grotto trip. **Man Eatin' Cave** is in the lower end of the same flow. There's reportedly a cave downflow from Man Eatin' Cave that has a pit about 300' upcave from the entrance. (I got this lead from a very reliable source.)
- **Lakelevel Cave** still needs to be mapped and a biological survey done. White-winged insects have been sighted and the Shasta Salamander (adult and juvenile) have been sighted on at least one occasion. There are two surface pits near Lakelevel as well...
- A physical connection between **Bobcat** and **Orange Tape Caves** may be possible with the aid of a rigid ladder. We may gain access to an entrance sink of Orange Tape Cave.
- Check out a cave system just east of **Giant Crater**. Lots of large passage plus blowing leads in breakdown. At least one ice cave is in the system.
- Watch **Yellowjacket Ice Cave** to see if it's open again next year. Recon Nov.'88 found going passage 8' wide, 4' high, over and down a gentle ice slope to a pool of water, and a junction of passage that appears to be going two ways.

The grotto **Leads List** has dozens of hot leads to chase down. Some will require more research or verification from their discoverers, while others have such specific location information that you may wonder why they haven't been looked at before!

Grotto members need to spend more time in "our" favorite caving areas close to home. The 1990 NSS Convention isn't that far away and we need to familiarize more members with cave locations near the convention site. **We need trip leaders!**

[Note to readers: The SAG RAG Index shown below follows the pagination of the original issues. For pdf-formatted issues, caves are indexed in the **Cave Index** accompanying the pdf versions – pdf ed.]

**SAG RAG INDEX 1982 - 1988, Vol. I - Vol. VII**

**Caves (by caving areas)**

**Limestone**

Tombstone Mtn.: I 5, 6; VI 1; VII 4;  
Packrat: map IV 4  
Wolverine: map V 3; map VII 4;  
Unnamed: VII 4;

**Gazelle**

Snake Pit: map VI 5;  
Unnamed: map VI 5

**Shasta Lake**

Melvin: sketch map II 1; II 6;  
Lakelevel: map III 4-6; map V 1; VII 5;  
Riley's: map III 2-3;  
Samwell: VI 3;

**McCloud Reservoir**

Battle Cr. (McCloud Res.): VI 4;  
Wellhella (Battle Cr.2): I 6; III 1;  
V 1, 5; VI 6; VII 4, 6;

**Trinity Mtns.**

Paul Gibson: II 5;  
French Horn: II 2, map II 4;  
Indian Cr.: III 1;  
Butter Cr.: III 1;

**Marble Mtns.: V 4; 1;**

Skunk Hollow: V 4;  
Speleocamp: II 5; III 4-6; IV 5; VI 5;  
Rainy: VII 4; V 4;  
Upstairs-Downstairs: V 4;

**Other States**

Oregon Caves, OR: V 4; VI 1;  
Carlsbad Caverns, NM: I 6;  
Star Peak, NV: III 4-6;  
Dead Horse, WA: V 6;

**Littoral, Etc.**

Patrick's Point: III 2-3; VI 2;

**Authors**

Henderson, P.: III 4-6; VI 3;  
Hesseldenz, T.: VI 4  
LaForge, D.: IV 5; VII 4-6;  
Jones, R.: V 5;  
Kisling, A.: II 4; IV 1, 3, 6; V 1; VI 1;  
Knutson, S.: V 4;  
Kottinger, J.: V 1;  
Marschner, J.: VI 3; VII 2;

**Safety**

Incident in the Marbles: I 5;  
First Aid Kit: II 2;  
Trip Leader Qualities: III 4-6  
Rescue Planning: IV 1, 3;

**Grotto**

Conservation: II 3; VII 1, 6;  
Constitution & Bylaws: II 1;  
Training: II 2; III 4-6;  
Logo: I 1-4; II 2

**SAG RAG Columns**

Cover Art: I 1-4; II 2; VI 1, 3-4, 6;  
V 1, 2-5; VI 1-3; VII 1, 2, 6;  
Cap'n Speleo&Boy Blunder: IV 3, 6; V 1; VI 1;  
Cave Leads: II 3; IV 5; VI 2;  
Equipment&Techniques: II 2; IV 2-3; V 2;  
VI 1; VII 4, 6;

**Caves, cont....**

**Lava Tube Systems**

**Double Hole Crater**

Porcupine Butte: II 3; VI 1;  
Kathy's Tube: map V 3;  
Sign: map VI 3;  
Deep Ice: VI 3;  
James Bros.: VII 5

**Giant Crater**

Powder Hill Complex: II 4;  
Roadside/Arch Complex: map VI 3;  
Shasta Valley: map VI 2;  
Pluto's: II 5; VI 2, 3;  
Barnum (Wind): III 1; VI 2, 5;  
Teeter Rock: IV 2, map VI 3; VII 4;  
Dance Hall: map VI 3; V 2; VII 4;  
Sand: map IV 5, 6;  
Windy: IV 2;

**Harris Mtn**

Red Tape: II 5; VI 2, map 3;  
Rediscovered: map VI 3;

**Hat Cr. Valley**

Subway: map IV 6  
Christmas Tree: VI 3

**Garner Mtn.**

Amoeba: map V 5;  
J. Jones Ice: map IV 4; VII 1, 4;  
Calf Skull: map V 5

**Unknown Flows**

Signal Flag: V 3  
Brown's wHole: VII 2

**Chimney Crater**

Freudian Complex: map VI 6; VII 4, 5

**Lava Beds**

Doc Yock & Stinking: map VII 5

**Authors, cont.**

Miller, R.: IV 2-3; V 2; VI 3, 5; VII 1, 4-6  
Rogers, B.: VII 5, 6;  
Smith, C.: I 1-4, 6; II 6; III 1, 2-3;  
Tyler T.: V 4; VII 4;  
Wolff, J.: I 5-6; II 3-5; III 1-6; IV 2-6;  
V 2, 5-6; VI 1-6; VII 1-6;  
Wolff, L.: IV 4, 6; V 4-6; VI 3; VII 1, 2, 4  
Wolff, M.: V 1;

**Safety, cont...**

Electric Lights: V 4;  
Brokedown Palace Accident: V 6;  
Kidney Stone: VI 5;  
Histoplasmosis: VII 5;

**Grotto, cont.**

Membership: I 1-4; II 2; III 1; IV 1;  
VI 1; VI 1; VII 2;  
Library: II 5;  
Science: V 5; VII 6;

**SAG RAG Columns, cont.**

Fiction: I 6; V 2;  
Grotto Notes: I 1-4, 5; II 3;  
History: I 5; IV 2;  
Humor: III 1; IV 3; V 2; VI 2; VII 2;  
Letters: II 3 -5; IV 5; V 2, 6; VII 2;  
Reviews: V 1, 3;

### 1989 Shasta Area Grotto Membership List

Wayne Babros	(916)287-3408	POB 965, Main St.	Alleghany	CA	95910	7671*
Rick Boatwright	(916)243-8439	5761 Jubilee St.	Redding	CA	96001	**
Mike Carnahan	(916)243-3874	2815 Nicole Ct.	Anderson	CA	96007	**
Thomas Currie	(707)668-5913	POB 94	Korbel	CA	95550	26971
Mark Dawson	(916)926-5682	POB 659, 1033 Nixon Rd.	Mt. Shasta	CA	96067	**
Glen Everest	(916)243-3873	2233 Butte St.	Redding	CA	96001	17903
Mark Fritzke	(707)827-1725	POB 4836	Arcata	CA	95521	16064
Al Henderson	(916)527-7513	14500 Kenney Ave.	Red Bluff	CA	96080	25329
Phylis						25330
Tom Hesseldenz	(916)926-2731w	101 E. Alma, Suite 100-E	Mt. Shasta	CA	96067	20516
Clarence Horner	(916)938-2167	7900 Ponderosa Drive	Weed	CA	96094	**
Evelyn						**
Norm Jenkins	(916)827-2082	POB 136	Herlong	CA	96113	23942*
Roger Jones	(707)722-4185	POB 26	Redcrest	CA	95569	22350*
Steve Knutson		POB	Mt. Shasta	CA	96067	5433
Jim Kottinger	(916)926-3975	1922 Highland Dr.	Mt. Shasta	CA	96067	26621
Dick LaForge	(707)443-2626	450 Redmond Rd.	Eureka	CA	95501	16560
John Marschner	(916)938-3347	777 S. Weed Blvd.	Weed	CA	96094	**
Ray Miller	(916)926-2440	POB 475, 1870 Highland Dr.	Mt. Shasta	CA	96067	25724
Joe Molter	(916)243-8924	2871 N. Bonnyview Rd.	Redding	CA	96001	6531*
Don Quinton	(619)247-7814	14122 Pawnee Rd.	Apple Valley	CA	92307	18354
George Reel	(916)938-4087	7908 Oakridge	Weed	CA	96094	**
Dorothy						**
Tim Rich	(916)275-6200	5563 Creek Trail Dr.	Redding	CA	96003	24897*
Claude Smith	(916)246-3942	PO 994293, 3645 Summit Dr.	Redding	CA	96099-	11980
Mary Belle					4293	13894*
Niels Smith	(916)254-6764	721-155 Alexander Way	Standish	CA	96128	23836
Wayne Smith	(916)926-2557	1737 Davis Pl. Rd.	Mt. Shasta	CA	96067	**
Todd Sobol	(707)822-1751	3235 Janes Rd.	Arcata	CA	95521	28471*
John Stein	(916)365-5404	3730 East Keswick Dam Rd.	Redding	CA	96003	**
Mark Stoute	(707)444-2126	POB 3106, 933 E. St.	Eureka	CA	95502	20600*
Max Tencher	(916)926-5164	2122 Hill Rd.	Mt. Shasta	CA	96067	28397
Jake Turin	(505)864-8246	39 Orchard	Belen	NM	87002	24770
Jim Wolff	(916)964-3123	POB 865, 516 Mill Rd.	McCloud	CA	96057	7572
Liz						11701

#### 1989 Shasta Area Grotto Officers

Chairman: Neil Smith Vice-chairman: Jim Kottinger  
Secretary: Liz Wolff Treasurer: Ray Miller

\* = not current NSS member

\*\* = non NSS member

---

#### Sunbeam Pit To Be Impacted by Powerline Project -

It has been noted that Sunbeam Pit will be directly underneath a powerline tower of this project. It is hoped that it can be handled at the District-level (i.e. Cavers to Ranger), but if not (!), we will need to take the time and make a public complaint of sorts and recommend that they move the tower a few hundred feet north of its proposed location.

---

**LETTERS TO THE EDITORS:** (an excerpt of a letter from Al and Phylis Henderson....)

“Hi! We are sure that if everyone else who receives the SAG RAG is as pleased with the cover as we are, you have some mighty pleased people. Liked those bats for pulling the sleigh, and all the rest.”

“Al crawled in a few caves this summer – mainly near Eagle Lake, but I did not. Wanted to explore some while at Dance Country [in McCloud]... but was doing good just to dance. OK now. Hopefully we will get back to caving when the weather gets better.”

Happy Caving-----  
Al & Phylis

**Letters Continued**.....here's one from Max Tenscher...

“... comment time drawing nigh on Tombstone (Mtn.) area FS sales, as you probably know. Important to protect the fragile limestone slopes...”

This jogs me back to an earlier reminder he gave us which WE never did anything about! If we have a concern that the “timber machine” will ruin this limestone country we love so much, we should get on the bandwagon and let the USFS folks know that there are some concerns for caves, although few caves have been found, a great potential is out there.



AFTER YOU GET PAST THE STALAGMITES  
IT'S AN EASY PUSH!  
by Ray Miller

**The SAG RAG**  
c/o Jim and Liz Wolff  
P.O. Box 865  
McCloud, CA 96057

FIRST CLASS MAIL

TO:

**TABLE OF CONTENTS**

Page 1	Calendar; 19 trapped cavers rescued; Loose ends and more leads
Page 2	SAG RAG Index 1982-1988, vol. I – Vol. VII
Page 3	Membership list
Page 4	Letters